



SECTION 4

MAINTENANCE, CLEANING AND ADJUSTMENT INFORMATION

ICE MAKER MAINTENANCE & CLEANING

The ice maker should never be allowed to operate without regular maintenance and cleaning. Keeping the unit clean and maintained will keep it sanitary, extend the life of the machine and keep energy consumption down. Maintenance and cleaning should be performed approximately every six months. Some water conditions will dictate even more frequent cleaning of the ice making section, just as some carpets and pets will dictate more frequent cleaning of the condenser.

The Five Things to Keep Clean

- The outside of cabinet and door
- The ice storage bin
- The ice scoop
- The condenser
- The ice making system

Cleaning the Outside of Cabinet and Door

To clean the outside of the cabinet and door (including the door gasket), wipe off spills as they occur. If anything spilled dries onto the surface, wash it off with a mild dish soap and warm water.

Cleaning/Sanitizing the Ice Storage Bin

Sanitizing the ice storage bin periodically is recommended. To do this, the unit must be switched OFF and the storage bin emptied. Then, mix a sanitizing solution consisting of one ounce household bleach with two gallons of hot (95°/35°C - 115°F/46°C) water. Using a clean soft cloth, wipe down the interior of the storage bin with the sanitizing solution (See Figure 4-1) and pour some of the solution down the bin drain. Rinse the interior of the storage bin with clean hot water and allow it to air dry before restarting the unit.

NOTE: It is recommended that cleaning/sanitizing the ice storage bin be performed immediately after the ice making system has been cleaned. (See next page.)

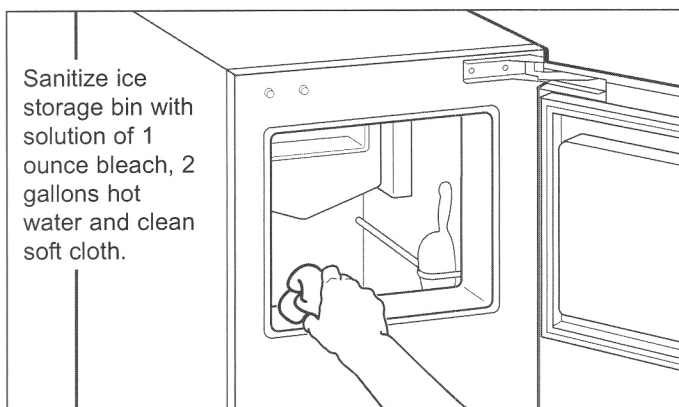

Figure 4-1. Cleaning/Sanitizing Ice Storage Bin

⚠ CAUTION

Never keep anything in the ice storage bin that is not ice. Objects such as beverage containers may be unsanitary and their labels might fall off which could plug the drain.

Cleaning the Ice Scoop

The ice scoop should be cleaned regularly to keep it sanitary. Clean the scoop with dish soap and warm water, as you would any other food container.

Cleaning the Condenser

The condenser is located at the right side of the compressor area, behind the kickplate and it looks similar to the radiator on a car. To clean the condenser, follow the directions below:

1. Remove the kickplate by extracting the two mounting screws, one at each side, and pull the kickplate down and forward.
2. With a brush attachment, vacuum the face of the condenser off while moving the brush up and down. (See Figure 4-2)

⚠ CAUTION

Do not bend the metal fins of the condenser, doing so will restrict airflow through the condenser, possibly causing mechanical failure of the ice maker.

3. After the condenser is clean, reattach the kickplate with the mounting screws.

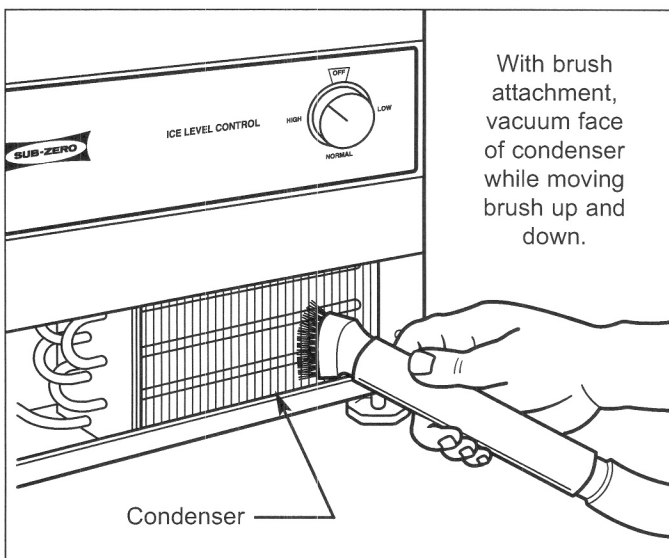

Figure 4-2. Condenser Cleaning



Cleaning the Ice Making System

Though the water system flushes away mineral impurities during the harvest cycle, some impurities will inevitably remain, sticking to parts of the ice machine, causing malformed ice cubes. This build up of mineral scale can shorten the life of the unit.

To keep the ice machine operating properly, these impurities or minerals will have to be dissolved regularly with ice machine cleaner. (Sub-Zero part #19034306)

⚠ WARNING

THE ICE MACHINE CLEANER SOLD BY SUB-ZERO CONTAINS ACIDS WHICH MAY CAUSE BURNS. ALWAYS WEAR HEAVY RUBBER GLOVES AND EYE PROTECTION WHEN WORKING WITH ICE MACHINE CLEANER.

IF ICE MACHINE CLEANER CONTACTS SKIN, FLUSH WITH WATER.

IF ICE MACHINE CLEANER CONTACTS EYES, FLUSH WITH LARGE AMOUNTS OF WATER AND CONTACT PHYSICIAN IMMEDIATELY.

IF SWALLOWED, DO NOT INDUCE VOMITING. DRINK LARGE AMOUNTS OF WATER OR MILK. CALL PHYSICIAN IMMEDIATELY.

KEEP ICE MACHINE CLEANER OUT OF REACH OF CHILDREN.

To clean the ice making system, follow the instructions below:

1. Turn ice machine control knob to OFF.
(See Figure 4-3)

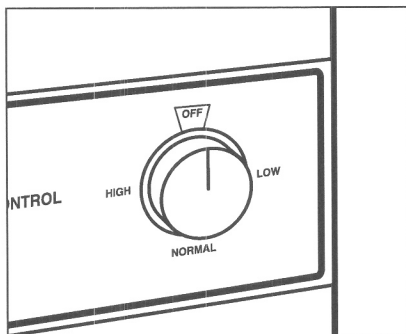

Figure 4-3. Control Turned OFF

2. Scoop all ice out of storage bin and either discard it or save it in an ice chest or cooler.
(See Figure 4-4)

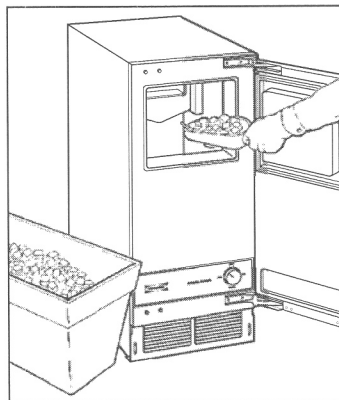

Figure 4-4. Empty Bin

3. Pour four ounces of Ice Machine Cleaner (part #19034306) into ice maker water reservoir.
(See Figure 4-5)

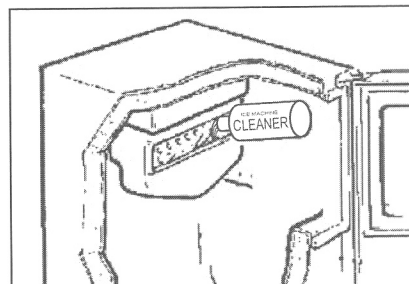

Figure 4-5.
Pour Cleaner into Reservoir

4. Turn ice machine control knob to ON and allow to run for approximately two hours (four ice making cycles).
(See Figure 4-6)

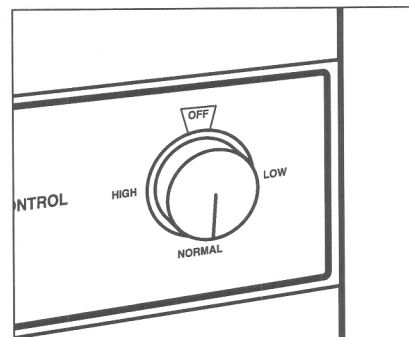

Figure 4-6. Control Turned ON
for Two Hours

5. Turn ice machine control knob to OFF, then pour hot (95°/35°C - 115°F/46°C) water into ice storage bin to melt ice that has been produced.
(See Figure 4-7)

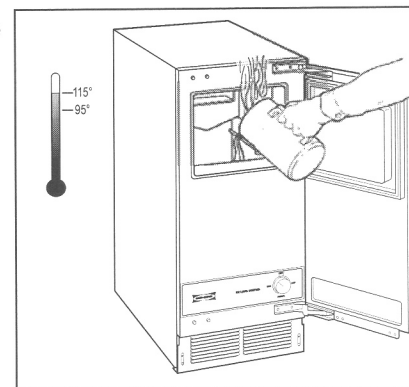

Figure 4-7.
Pour Hot Water into Bin

6. Clean bin liner of mineral scale by mixing a small amount of ice machine cleaner with hot water. Using a clean soft cloth, wipe down bin liner with this solution, then rinse with clean hot water.
7. Clean/sanitize ice storage bin as described earlier.
8. Turn ice machine control knob to ON and replace ice removed in step 2.

Winterizing the Ice Machine

The instructions below are for those units installed in homes left unoccupied for extended periods of time during winter months. If the ice maker is in a residence used year round, these directions need not be followed.

1. Clean the ice making system, condenser and ice storage bin as described on the preceding pages.
2. Turn off the water supply to the unit.
3. Locate the bottom hose that runs from the circulating/spray pump to the reservoir. Loosen the hose clamp on that hose and disconnect the hose from the reservoir. (See Figure 4-8) This will drain the reservoir.
4. Pull the control knob from the ice machine control shaft. (See Figure 4-9)
5. Remove the control face plate by pulling the top forward to disengage the velcro strips, then lift up. (See Figure 4-9)
6. Remove the inner control access panel by extracting the three screws, then lower the panel slightly and pull forward. (See Figure 4-9)
7. Locate the water valve and disconnect the inlet water line from the water valve. (See Figure 4-10)
8. Locate the cycle timer and rotate the shaft clockwise until the cam is in the harvest cycle position (switch button out). (See Figure 4-11)
9. With the appliance operating, blow air through the water valve with a tire pump or similar device. This will purge the valve and water system of water.
10. If winterizing a model 315IP (with drain pump), pour 1/2 gallon of "RV antifreeze" (propylene glycol) down the bin drain.

⚠ CAUTION

Do not use automotive antifreeze as this is unsanitary and may damage the appliance. The antifreeze must be propylene glycol.

11. Switch the unit to OFF, prop the door open and disconnect power to the ice maker.

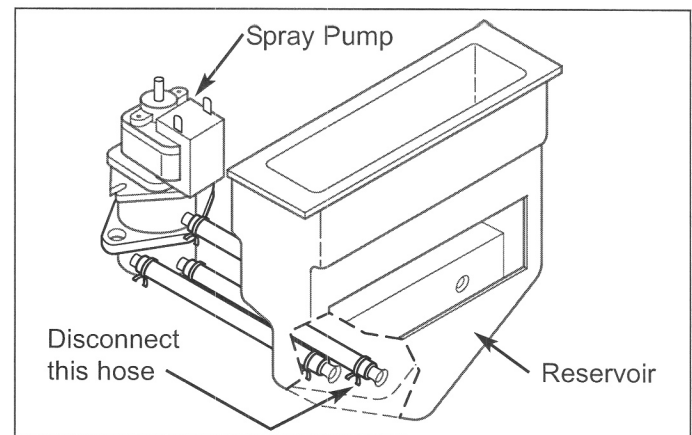

Figure 4-8. Emptying Water from Reservoir

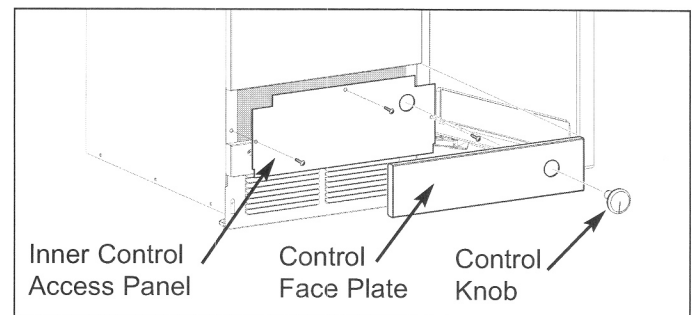

Figure 4-9. Remove Control Knob, Face Plate & Access Panel

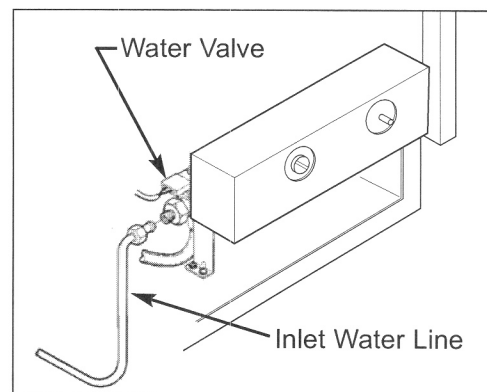

Figure 4-10. Disconnect Water Line

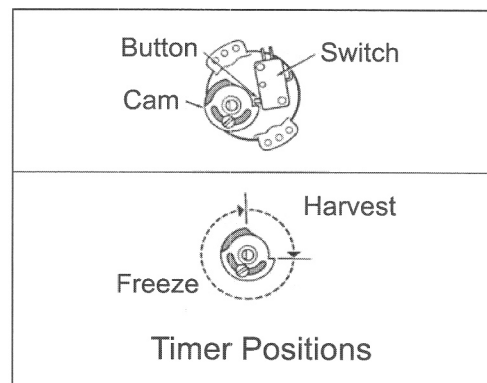

Figure 4-11. Rotate Timer Cam to Harvest Position

ADJUSTMENTS

There are three items that may be adjusted: Cube Size, Harvest Cycle Time and Bin Ice Level.

NOTE: *Cube Size and Harvest Cycle Time Adjustments should only be performed by a qualified technician.*

Cube Size Control Adjustment

The cube size control should only be adjusted to bring the cubes to the correct shape. The actual overall size cannot be adjusted. This adjustment should be performed when the ice machine is in the harvest cycle or within the first ten minutes of the freeze cycle.

Follow the steps below to adjust the cube size:

- 1) Open the door and remove the control knob, the control face plate and the inner control access panel. (See Figure 4-12)

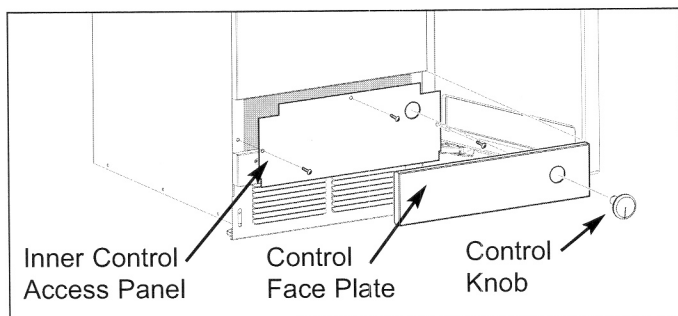

Figure 4-12.

Remove Control Knob, Face Plate & Access Panel

2. Locate the cube size adjustment screw. (See Figure 4-13)
 - a. To make the cubes fuller, turn the screw clockwise approximately 1/4 turn. This will increase the freeze cycle time.
 - b. To shorten the freeze cycle time and decrease the fullness of the cubes, turn the screw counterclockwise approximately 1/4 turn.
3. After the following freeze cycle the cubes should have responded to the adjustment. (See Figure 4-14 for proper cube size) If further adjustments are required, perform the adjustments early in the freeze cycle.

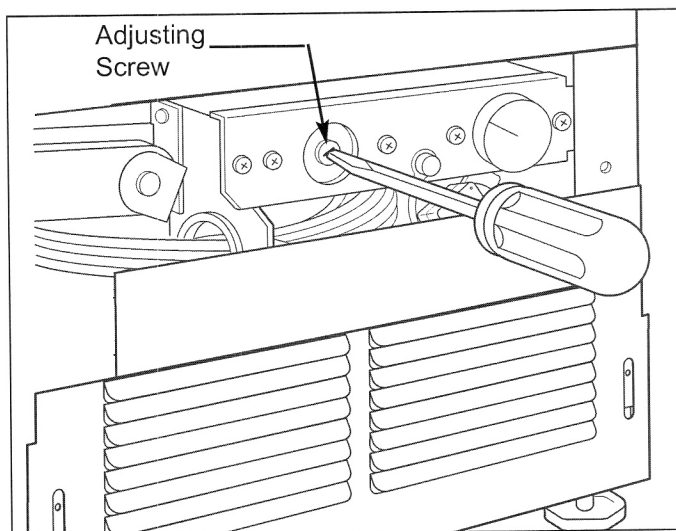

Figure 4-13. Turn Cube Size Adjustment Screw

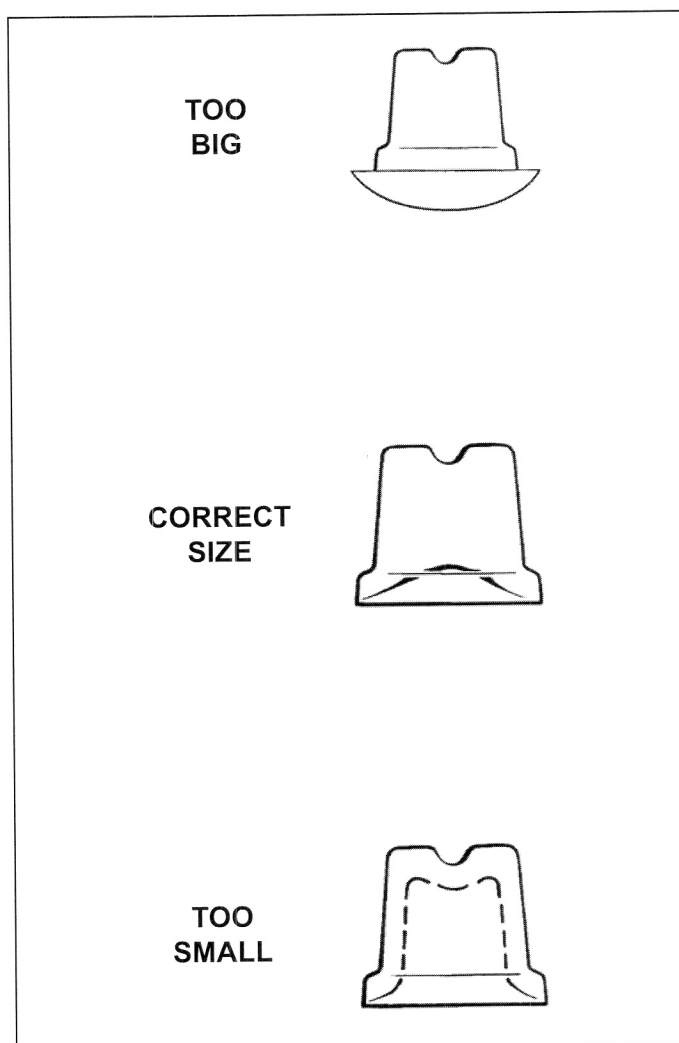

Figure 4-14. Ice Cubes

Bin Ice Level Adjustment

When the ice machine shuts off, the ice level in the bin should be even with the metal tube inside the bin. If the ice in the bin is too high or too low, turn the ice machine control knob to adjust the bin thermostat accordingly. See instructions below:

1. To lower the ice level, turn the control knob counter-clockwise. Usually 1/8 turn will be enough. (See Figure 4-15)
2. To increase the ice level, turn the control knob clockwise. Usually 1/8 turn will be enough. (See Figure 4-16)

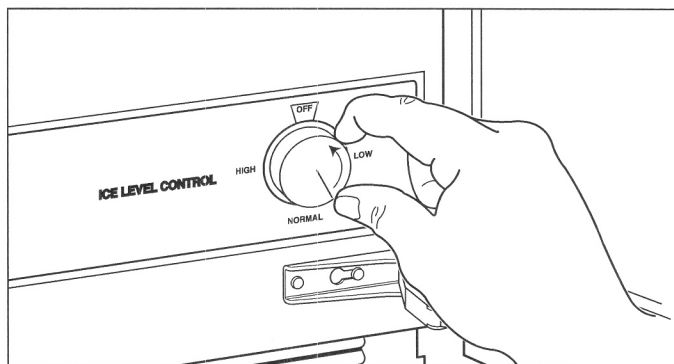

Figure 4-15. Decrease Ice Level

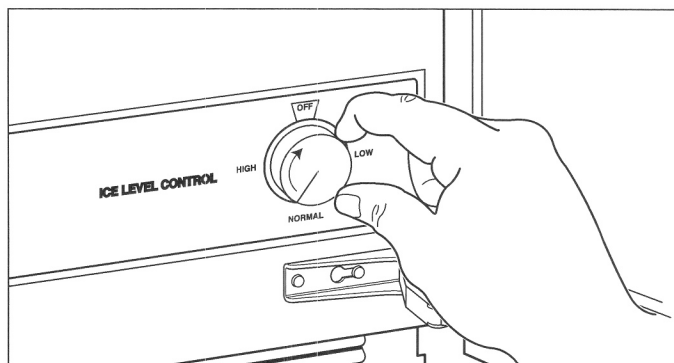

Figure 4-16. Increase Ice Level

Harvest Cycle Time Adjustment

The harvest cycle time is set at the factory for approximately three minutes, which should be adequate to release all the cubes and fill the reservoir. If the timer needs to be adjusted, follow the directions below:

1. Disconnect electrical power to the unit.

⚠ WARNING

**ELECTRICAL SHOCK HAZARD.
POWER TO THE UNIT MUST BE DISCONNECTED BEFORE ATTEMPTING THIS ADJUSTMENT.**

2. Remove the control knob, the control face plate and the inner control access panel. (See Figure 4-17)
3. Locate the timer and loosen the set screw that holds the two halves of the timer cam together.
4. Rotate one half of the cam to either open or close the lower portion of the cam. More open increases harvest time, less open decreases harvest time. (See Figure 4-18)
5. Tighten the set screw and replace the control knob, the control face plate and the inner control access panel.
6. Reconnect power to the unit.

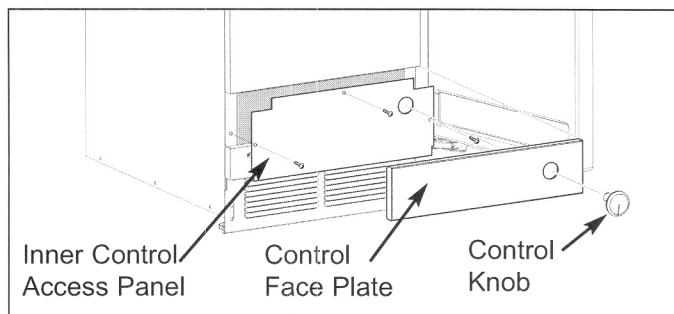

Figure 4-17.
Remove Control Knob, Face Plate & Access Panel

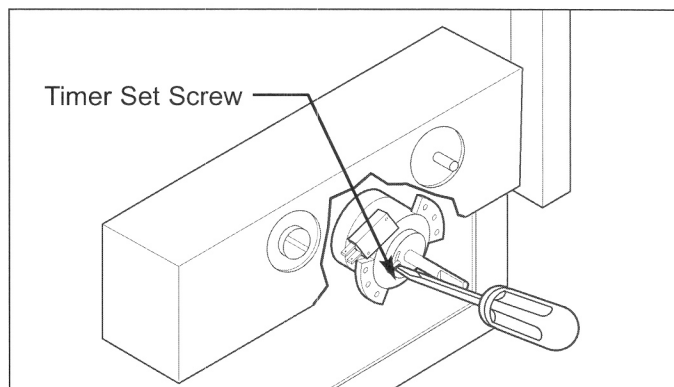

Figure 4-18. Loosen Set Screw